

Box Only:
CHB121212

Polymer Concrete
Cover

Cover Only:
CHC1212XXX

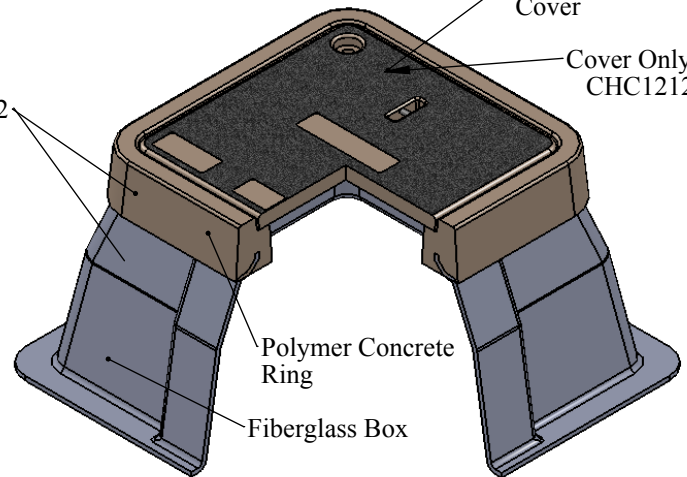

Polymer Concrete
Ring

Fiberglass Box

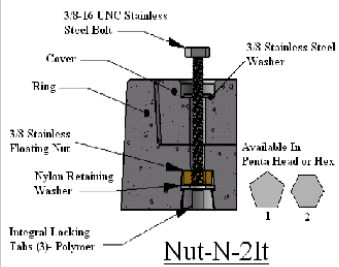

Rev.B Was for Cover Dimension change.

PROPRIETARY AND CONFIDENTIAL
THE INFORMATION CONTAINED IN THIS DRAWING IS THE SOLE PROPERTY OF HIGHLINE PRODUCTS. ANY REPRODUCTION IN PART OR AS A WHOLE WITHOUT THE WRITTEN PERMISSION OF HIGHLINE PRODUCTS IS PROHIBITED.

UNLESS OTHERWISE SPECIFIED:	NAME	DATE
DIMENSIONS ARE IN INCHES TOLERANCES: $\pm 1/8"$ FRACTIONAL \pm ANGULAR: MACH \pm BEND \pm TWO PLACE DECIMAL \pm THREE PLACE DECIMAL \pm	DRAWN/ ENG. SK	05.24.11
INTERPRET GEOMETRIC TOLERANCING PER:	CHECKED	
MATERIAL: Polymer Concrete/ Fiberglass FINISH	HIGHLINE APPR.	
DO NOT SCALE DRAWING	MFG APPR.	
	Q.A.	
	BOX WEIGHT= 36 lbs.	
	COVER WEIGHT = 10 lbs.	
	UNITS PER PALLET= # 30	

HIGHLINE
PRODUCTS

Composite Handhole Assembly
Model CHA121212
Tier8 (S) 12,000 lbs., Tier15 (H) 22,500 lbs.

SIZE DWG. NO.	REV
A CHA121212	B
SCALE: NTS	SHEET 1 OF 1